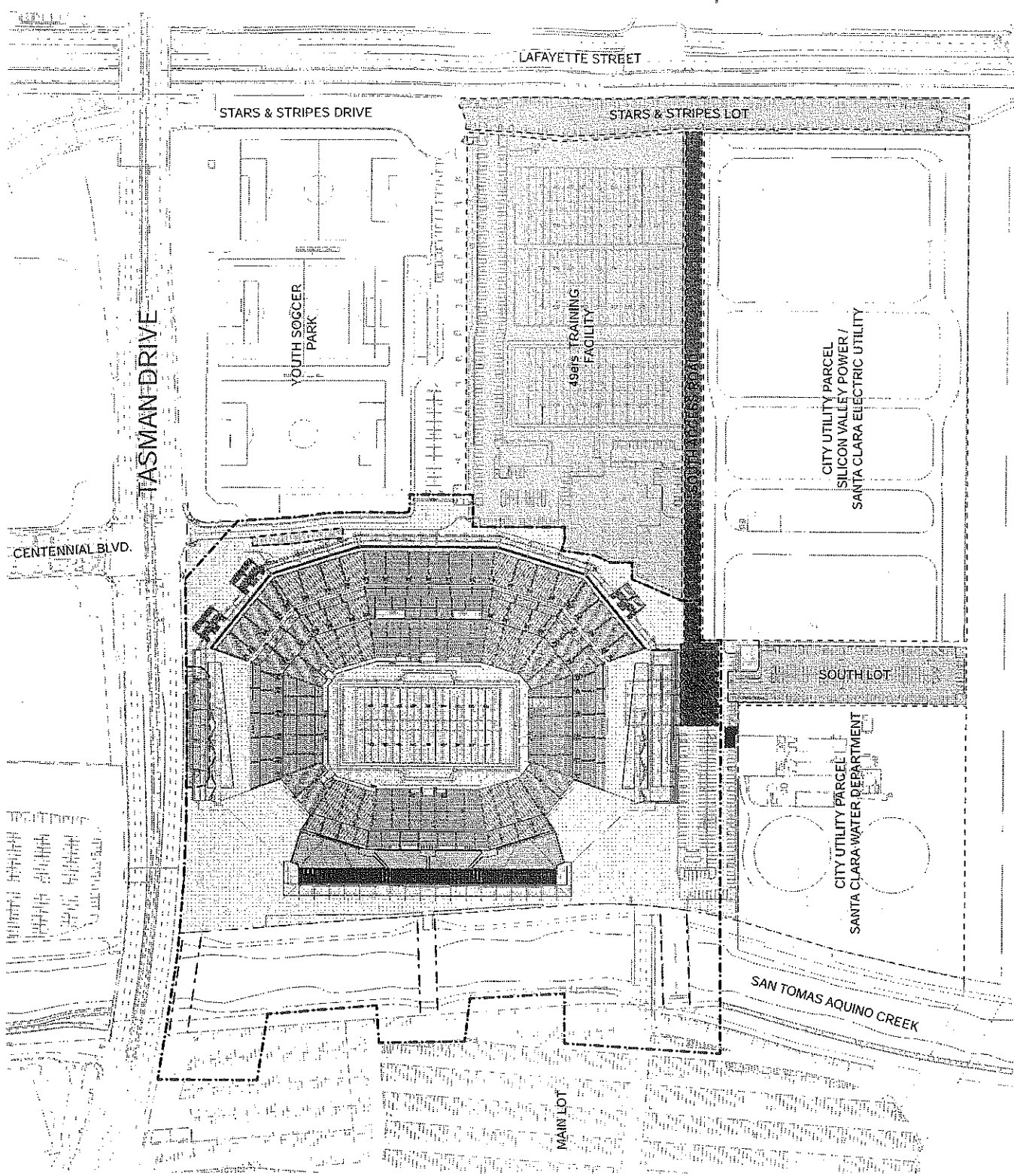

EXHIBIT C-1  
TO STADIUM LEASE

SITE PLAN



**LEGEND**

- 1. STADIUM AND STADIUM ANCILLARY PROPERTY
- 2. CITY UTILITY PARCEL - SANTA CLARA WATER DEPARTMENT
- 3. CITY UTILITY PARCEL - SILICON VALLEY POWER / SANTA CLARA ELECTRIC UTILITY
- 4. SOUTH LOT
- 5. SOUTH ACCESS ROAD
- 6. STARS & STRIPES LOT
- 7. TRAINING FACILITY PARCEL
- 8. TENANT'S PARKING SPACES
- 9. STADIUM AUTHORITY EXCLUSIVE PARKING
- 10. REQUIRED NFL SECURITY AREA & FACILITIES



PLAN NORTH



March 15, 2012

**OVERALL SITE PLAN**

EXHIBIT C-2  
TO STADIUM LEASE

STADIUM PLANS

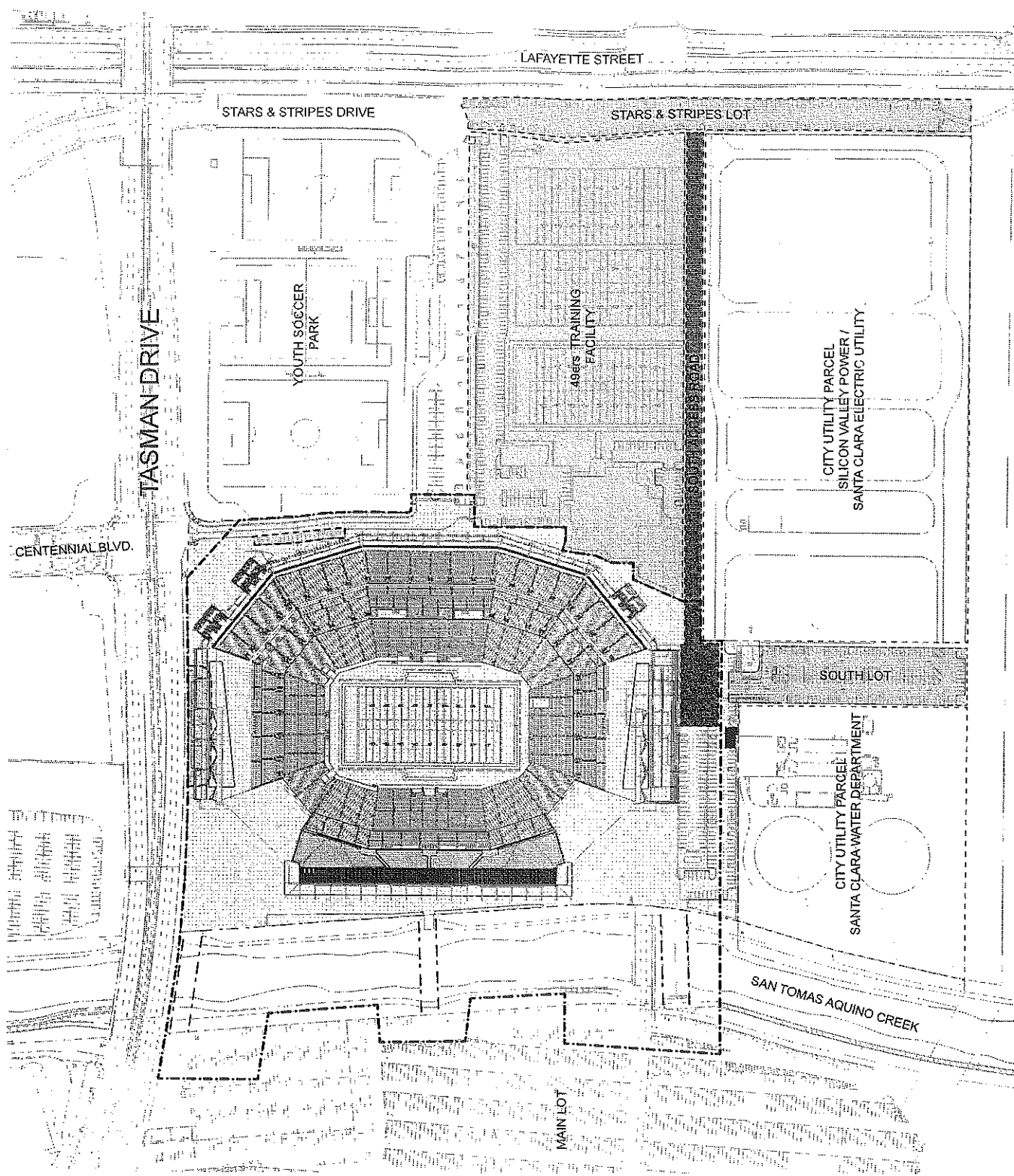

**LEGEND**

- 1. STADIUM AND STADIUM ANCILLARY PROPERTY
- 2. CITY UTILITY PARCEL - SANTA CLARA WATER DEPARTMENT
- 3. CITY UTILITY PARCEL - SILICON VALLEY POWER / SANTA CLARA ELECTRIC UTILITY
- 4. SOUTH LOT
- 5. SOUTH-ACCESS ROAD
- 6. STARS & STRIPES LOT
- 7. TRAINING FACILITY PARCEL
- 8. TENANT'S PARKING SPACES
- 9. STADIUM AUTHORITY EXCLUSIVE PARKING
- 10. REQUIRED NFL SECURITY AREA & FACILITIES



PLAN NORTH



March 15, 2012

**OVERALL SITE PLAN**



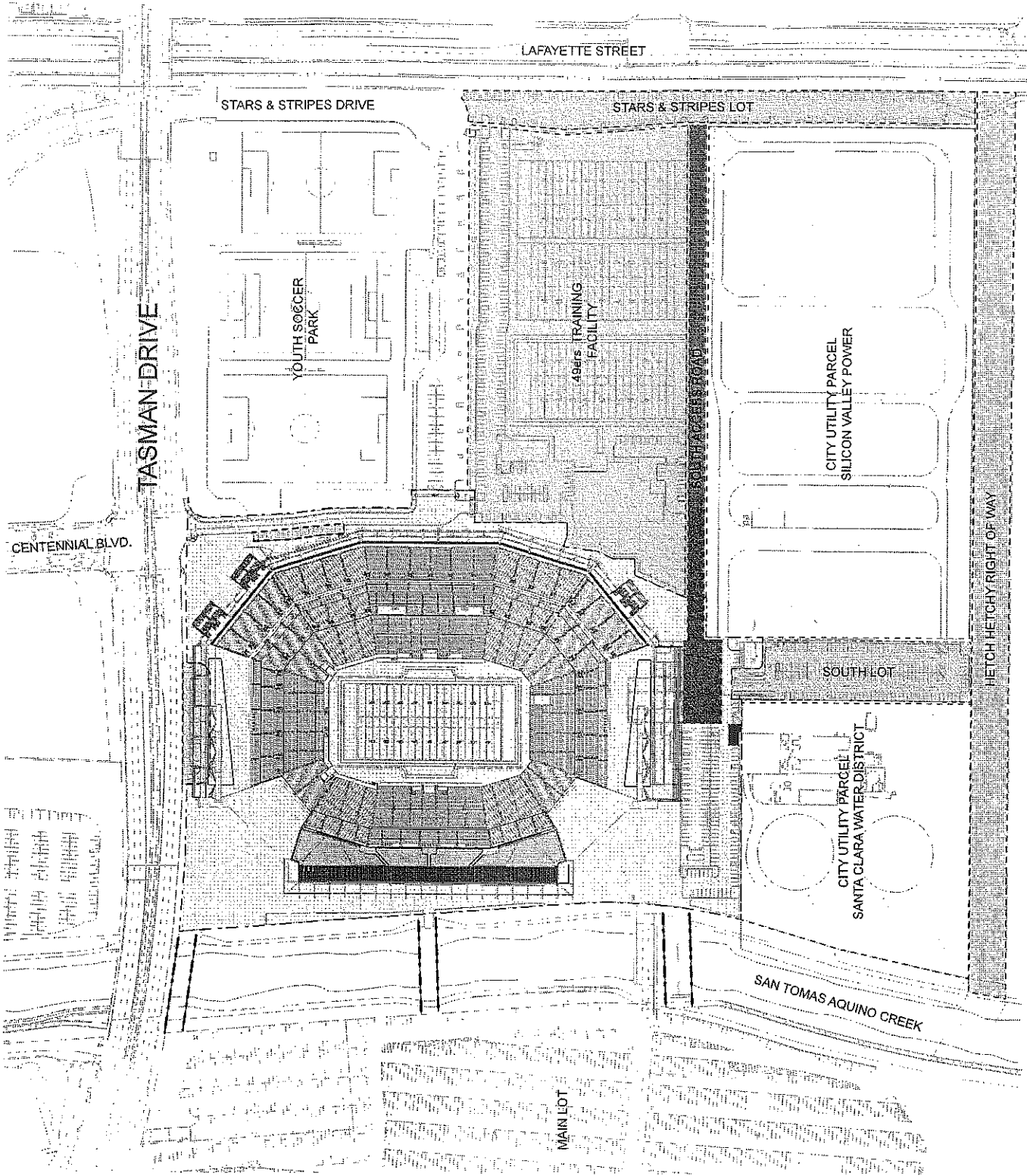

**LEGEND**

- 1. STADIUM AND STADIUM ANCILLARY PROPERTY
- 2. CITY UTILITY PARCEL - SANTA CLARA WATER DISTRICT
- 3. CITY UTILITY PARCEL - SILICON VALLEY POWER
- 4. SOUTH LOT
- 5. SOUTH ACCESS ROAD
- 6. STARS & STRIPES LOT
- 7. TRAINING FACILITY PARCEL
- 8. TENANT'S PARKING SPACES
- 9. STADIUM AUTHORITY EXCLUSIVE PARKING
- 10. HETCH HETCHY RIGHT OF WAY



PLAN NORTH



**OVERALL SITE PLAN**

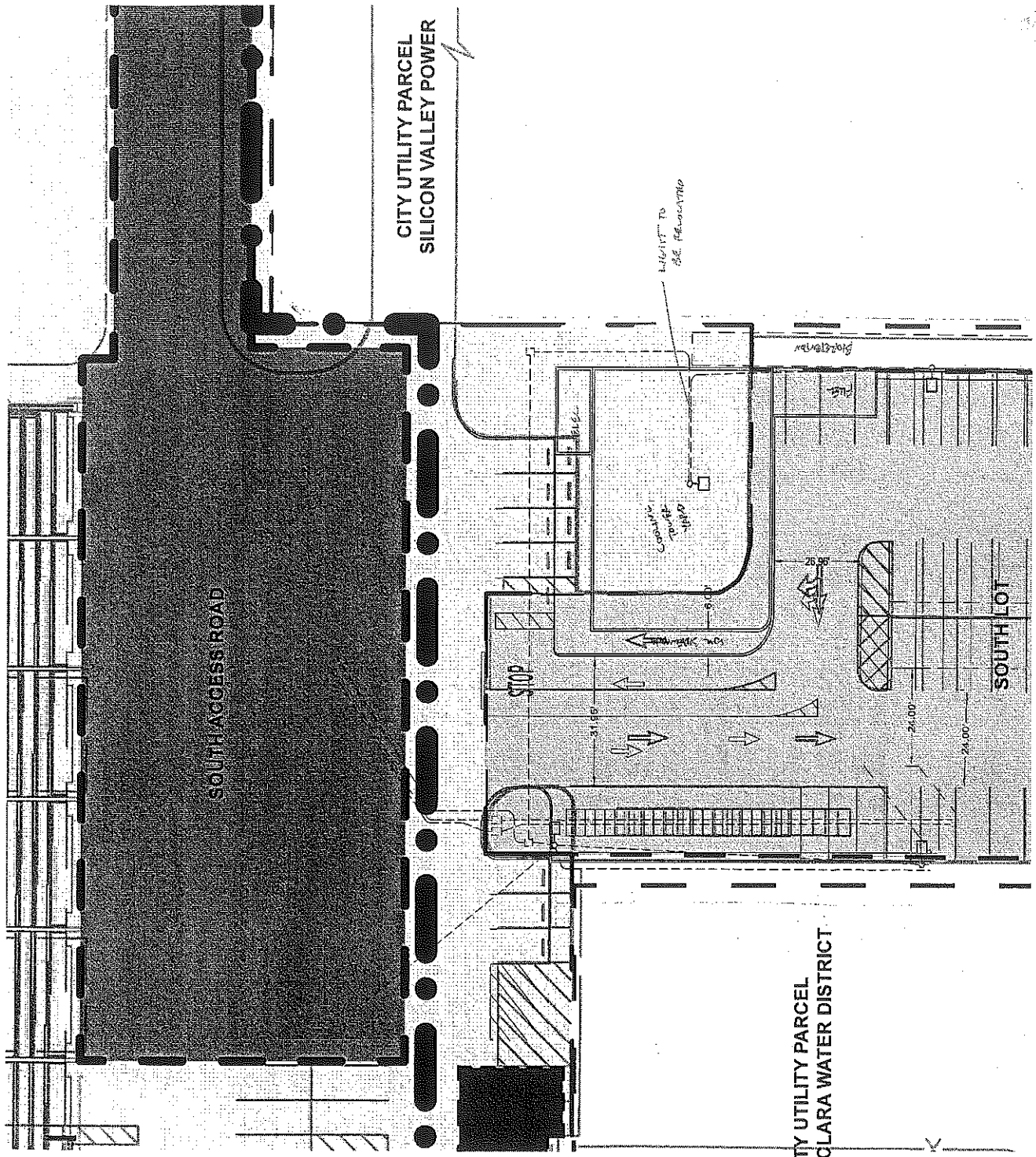

**LEGEND**

- 1. STADIUM AND STADIUM ANCILLARY PROPERTY
- 2. CITY UTILITY PARCEL - SANTA CLARA WATER DEPARTMENT
- 3. CITY UTILITY PARCEL - SILICON VALLEY POWER / SANTA CLARA ELECTRIC UTILITY
- 4. SOUTH LOT
- 5. SOUTH ACCESS ROAD
- 6. STARS & STRIPES LOT
- 7. TRAINING FACILITY PARCEL
- 8. TENANT'S PARKING SPACES
- 9. STADIUM AUTHORITY EXCLUSIVE PARKING
- 10. REQUIRED NFL SECURITY AREA & FACILITIES



PLAN NORTH



March 19, 2012

**SOUTH LOT - COOLING TOWER . FUEL STORAGE . ELECTRICAL**

**LEGEND**

- 1. STADIUM AND STADIUM ANCILLARY PROPERTY
- 2. CITY UTILITY PARCEL - SANTA CLARA WATER DEPARTMENT
- 3. CITY UTILITY PARCEL - SILICON VALLEY POWER / SANTA CLARA ELECTRIC UTILITY
- 4. SOUTH LOT
- 5. SOUTH-ACCESS ROAD
- 6. STAIRS & STRIPES LOT
- 7. TRAINING FACILITY PARCEL
- 8. TENANT'S PARKING SPACES
- 9. STADIUM AUTHORITY EXCLUSIVE PARKING
- 10. --- REQUIRED NFL SECURITY AREA & FACILITIES

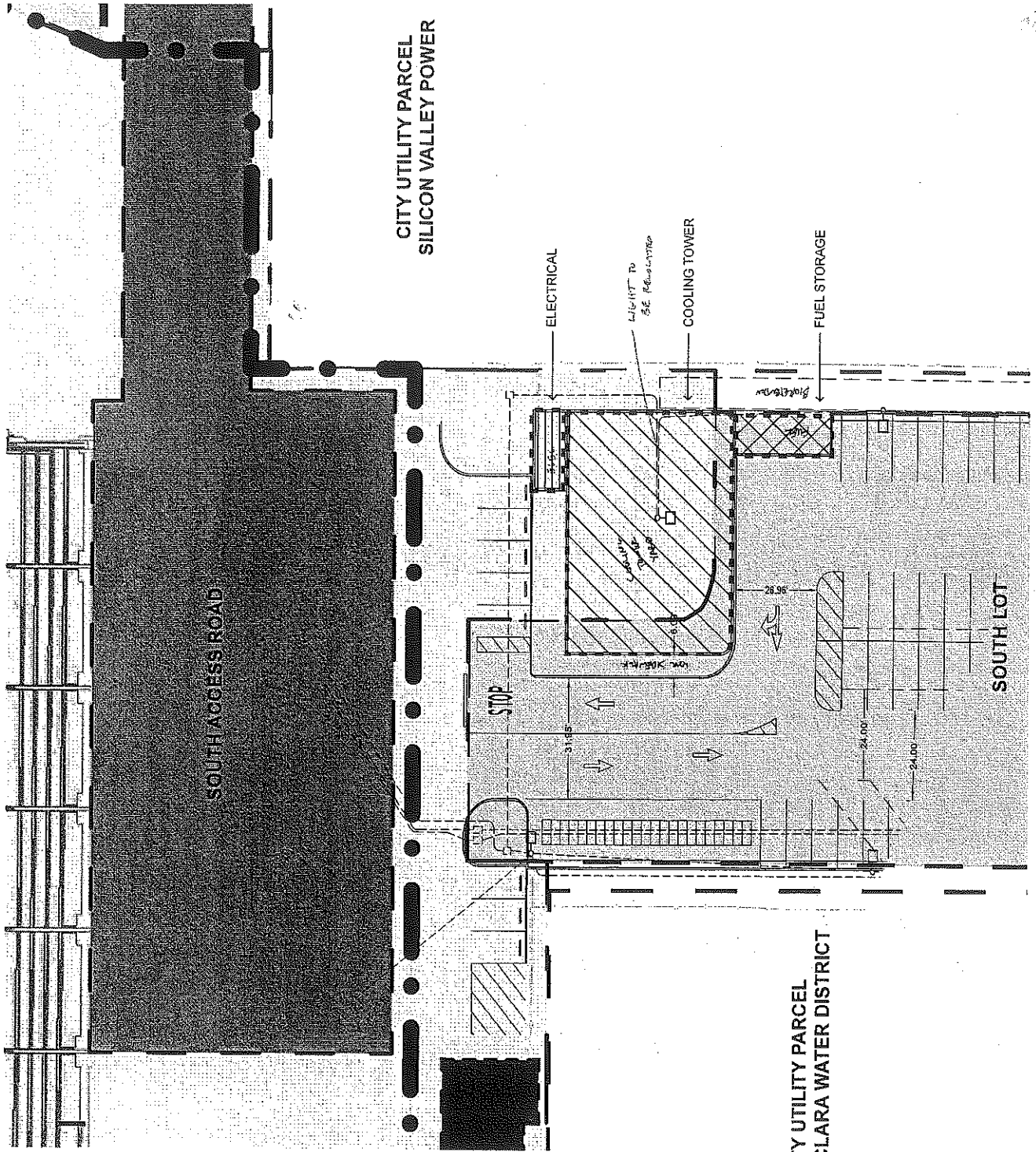

CITY UTILITY PARCEL  
SILICON VALLEY POWER

CITY UTILITY PARCEL  
SANTA CLARA WATER DISTRICT

SOUTH LOT



PLAN NORTH



March 15, 2012

SOUTH LOT - COOLING TOWER . FUEL STORAGE . ELECTRICAL



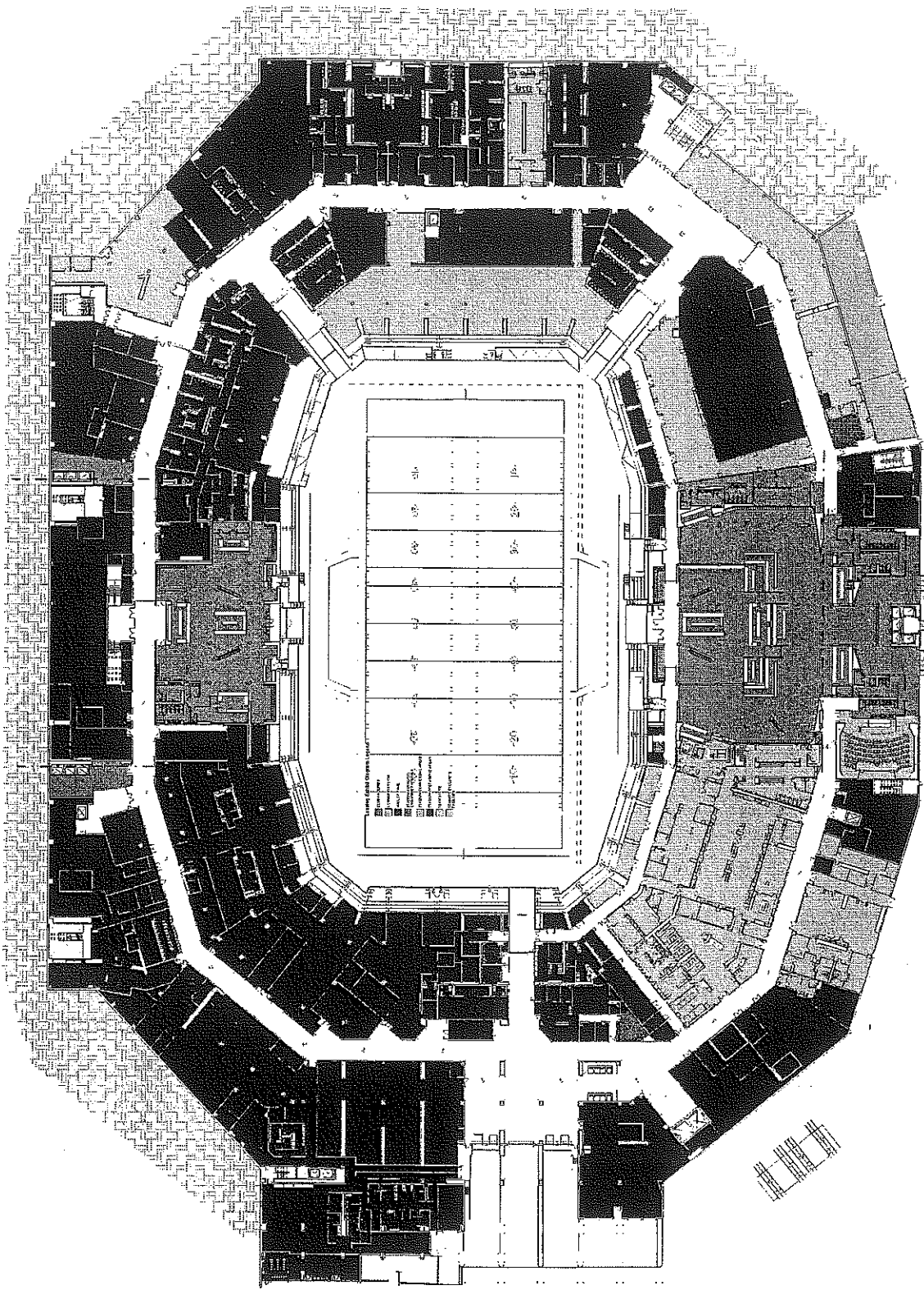

**LEGEND**

1. **STADIUM OPERATIONS AREAS**  
 Concessions  
 Press Box  
 Sales, Club & Peltier Department  
 Restrooms  
 Security Command  
 Storage  
 Day of Game Employee Building  
 Video Bank Facilities  
 Paper Goods Storage  
 Mechanical, Electrical, Plumbing  
 Maintenance  
 Multi-Purpose Room  
 Trash/Recycling
2. **TENANT'S EXCLUSIVE FACILITIES**
3. **HALL OF FAME**  
 (Tenant's Exclusive Facilities, Stadium Commercial Areas)
4. **TEAM STORE**  
 (Tenant's Exclusive Facilities, Stadium Commercial Areas)
5. **PREMIUM STADIUM AREAS**
6. **COMMUNITY ROOM**
7. **STADIUM AUTHORITY EXCLUSIVE FACILITIES**
8. **CLUB FACILITIES**  
 (Premium Stadium Areas)
9. **OWNER'S CLUB**  
 (Tenant's Exclusive Facilities)
10. **STADIUM COMMERCIAL AREAS**  
 (Tenant's Exclusive Facilities)
11. **SUITE TOWER**  
 (Tenant's Exclusive Facilities)
12. **TENANT'S ADMINISTRATIVE SPACE**  
 (Tenant's Exclusive Facilities)
13. **STADIUM TICKET OFFICE**  
 (Tenant's Exclusive Facilities)
14. **STADIUM AUDIO / VIDEO FACILITIES**  
 (Tenant's Exclusive Facilities)

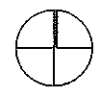

PLAN NORTH



March 15, 2012  
**100 LEVEL - FIELD**



**LEGEND**

**1. STADIUM OPERATIONS AREAS**

- Concessions
- Restroom
- Bank/Class Police Department
- Security Command
- Day of Game Employee Briefing
- Blow-Up Team Facilities
- Paper Goods Storage
- Mechanical, Electrical, Plumbing
- Locker Rooms
- Mail/Postage
- Mail Recovery

**2. TENANT'S EXCLUSIVE FACILITIES**

- HALL OF FAME  
(Tenant's Exclusive Facilities, Stadium Commercial Areas)

**3. TEAM STORE**

- (Tenant's Exclusive Facilities, Stadium Commercial Areas)

**4. PREMIUM STADIUM AREAS**

- COMMUNITY ROOM

**5. STADIUM AUTHORITY EXCLUSIVE FACILITIES**

- CLUB FACILITIES  
(Premium Stadium Areas)

**6. OWNERS'S CLUB**

- (Tenant's Exclusive Facilities)

**7. STADIUM COMMERCIAL AREAS**

- SUITE TOWER  
(Tenant's Exclusive Facilities)

**8. TENANT'S ADMINISTRATIVE SPACE**

- (Tenant's Exclusive Facilities)

**9. STADIUM TICKET OFFICE**

- (Tenant's Exclusive Facilities)

**10. STADIUM AUDIO / VIDEO FACILITIES**

- (Tenant's Exclusive Facilities)

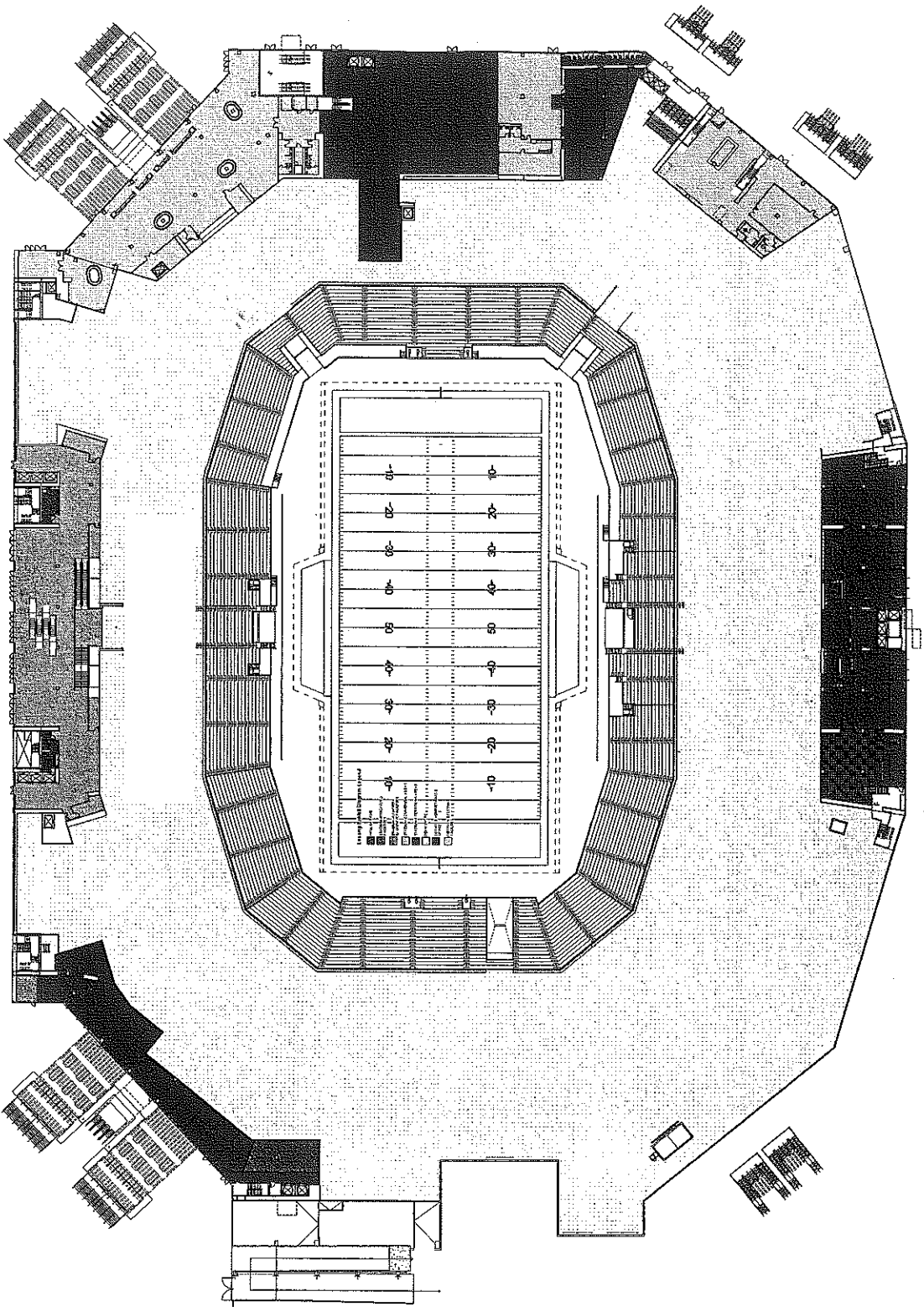

PLAN NORTH



March 15, 2012  
**200 LEVEL - PLAZA**

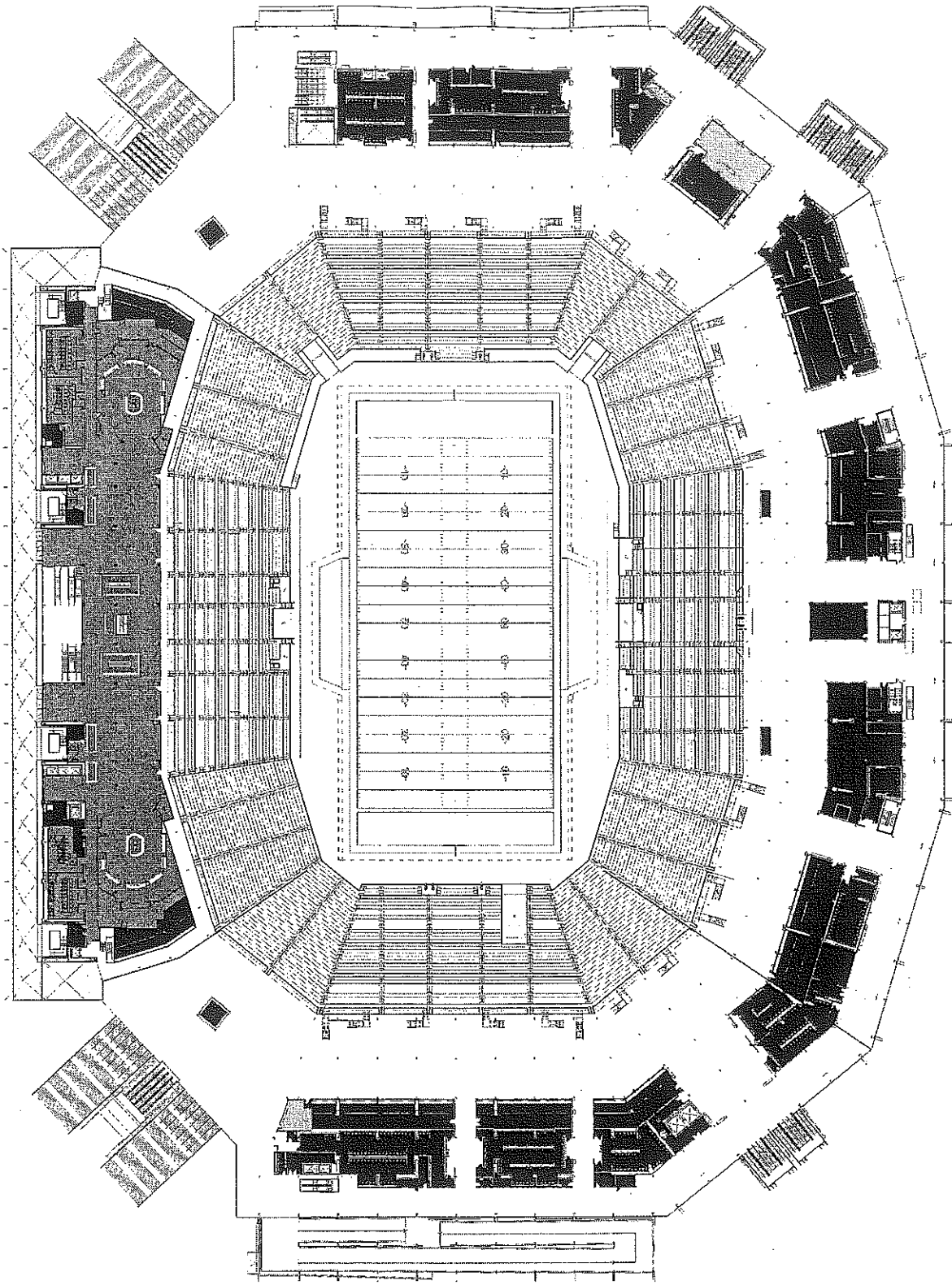

**LEGEND**

- 1. **STADIUM OPERATIONS AREAS**  
 Restrooms  
 Security  
 Sports Club Police Department  
 Engineering  
 Food  
 Day of Game Employee Briefing  
 Auxiliary Locker Room  
 Staircases  
 Green Rooms  
 Multi-Purpose Room
- 2. **TENANT'S EXCLUSIVE FACILITIES**
- 3. **HALL OF FAME**  
 (Tenant's Exclusive Facilities, Stadium Commercial Areas)
- 4. **TEAM STORE**  
 (Tenant's Exclusive Facilities, Stadium Commercial Areas)
- 5. **PREMIUM STADIUM AREAS**
- 6. **COMMUNITY ROOM**
- 7. **STADIUM AUTHORITY EXCLUSIVE FACILITIES**
- 8. **CLUB FACILITIES**  
 (Premium Stadium Areas)
- 9. **OWNER'S CLUB**  
 (Tenant's Exclusive Facilities)
- 10. **STADIUM COMMERCIAL AREAS**  
 (Tenant's Exclusive Facilities)
- 11. **SUITE TOWER**  
 (Tenant's Exclusive Facilities)
- 12. **TENANT'S ADMINISTRATIVE SPACE**  
 (Tenant's Exclusive Facilities)
- 13. **STADIUM TICKET OFFICE**  
 (Tenant's Exclusive Facilities)
- 14. **STADIUM AUDIO / VIDEO FACILITIES**  
 (Tenant's Exclusive Facilities)



PLAN NORTH



March 15, 2012  
**300 LEVEL - MAIN CONCOURSE**



**LEGEND**

**1. STADIUM OPERATIONS AREAS**

- Construction
- Restrooms
- Police
- Public Safety Department
- Security
- Signage
- Suitcases
- Turf Management
- Video
- Workshop
- Day of Game Employee Building
- Auxiliary Locker Room
- Field Photographers
- Green Room
- Green Room
- Multi-Purpose Room

**2. TENANT'S EXCLUSIVE FACILITIES**

**3. HALL OF FAME**  
(Tenant's Exclusive Facilities, Stadium Commercial Area)

**4. TEAM STORE**  
(Tenant's Exclusive Facilities, Stadium Commercial Area)

**5. PREMIUM STADIUM AREAS**

**6. COMMUNITY ROOM**

**7. STADIUM AUTHORITY EXCLUSIVE FACILITIES**

**8. CLUB FACILITIES**  
(Premium Stadium Area)

**9. OWNER'S CLUB**  
(Tenant's Exclusive Facilities)

**10. STADIUM COMMERCIAL AREAS**  
(Tenant's Exclusive Facilities)

**11. SUITE TOWER**  
(Tenant's Exclusive Facilities)

**12. TENANT'S ADMINISTRATIVE SPACE**  
(Tenant's Exclusive Facilities)

**13. STADIUM TICKET OFFICE**  
(Tenant's Exclusive Facilities)

**14. STADIUM AUDIO / VIDEO FACILITIES**  
(Tenant's Exclusive Facilities)

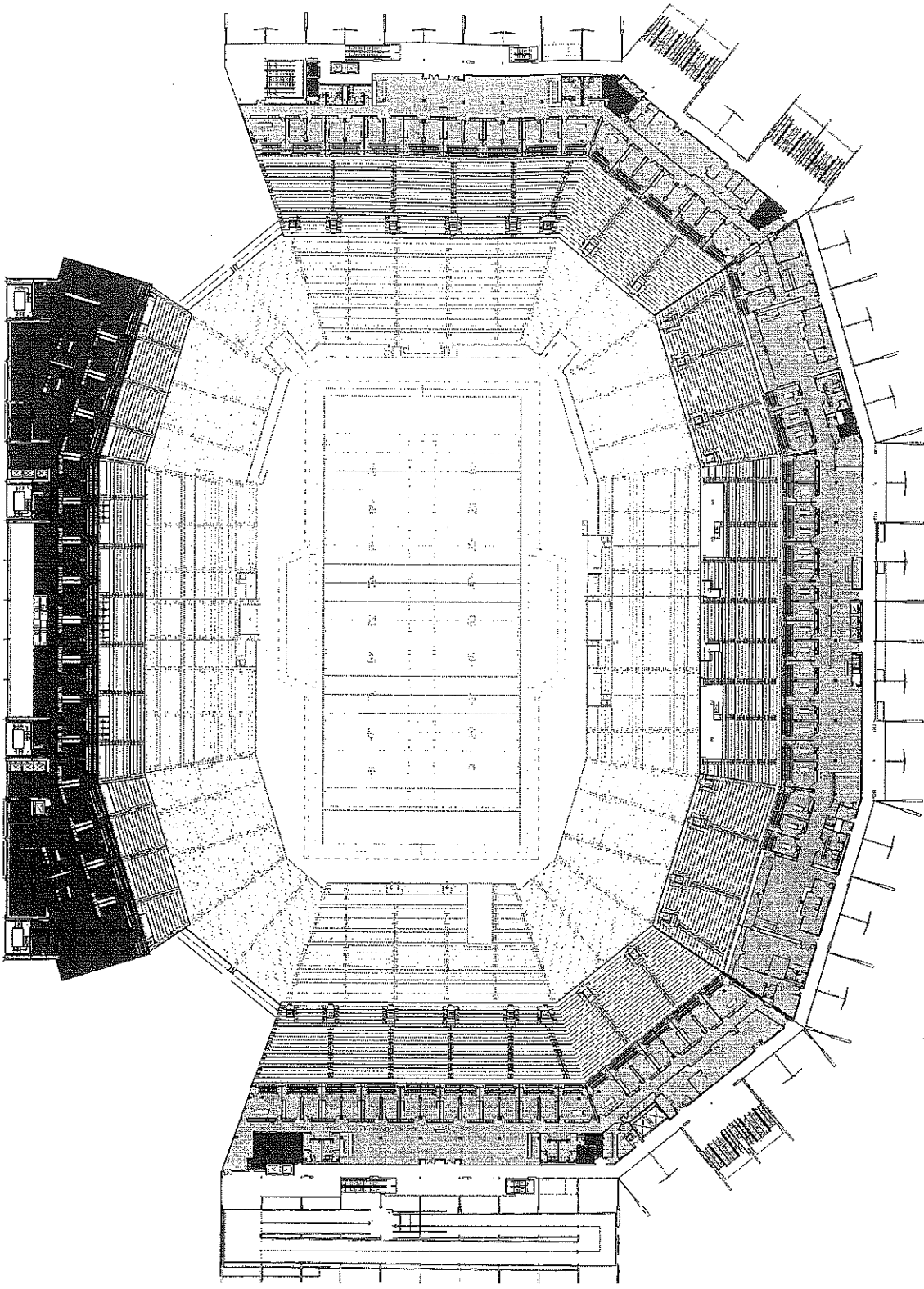

PLAN NORTH



March 15, 2012

**500 LEVEL - SUITES AND PREMIUM AMENITIES**

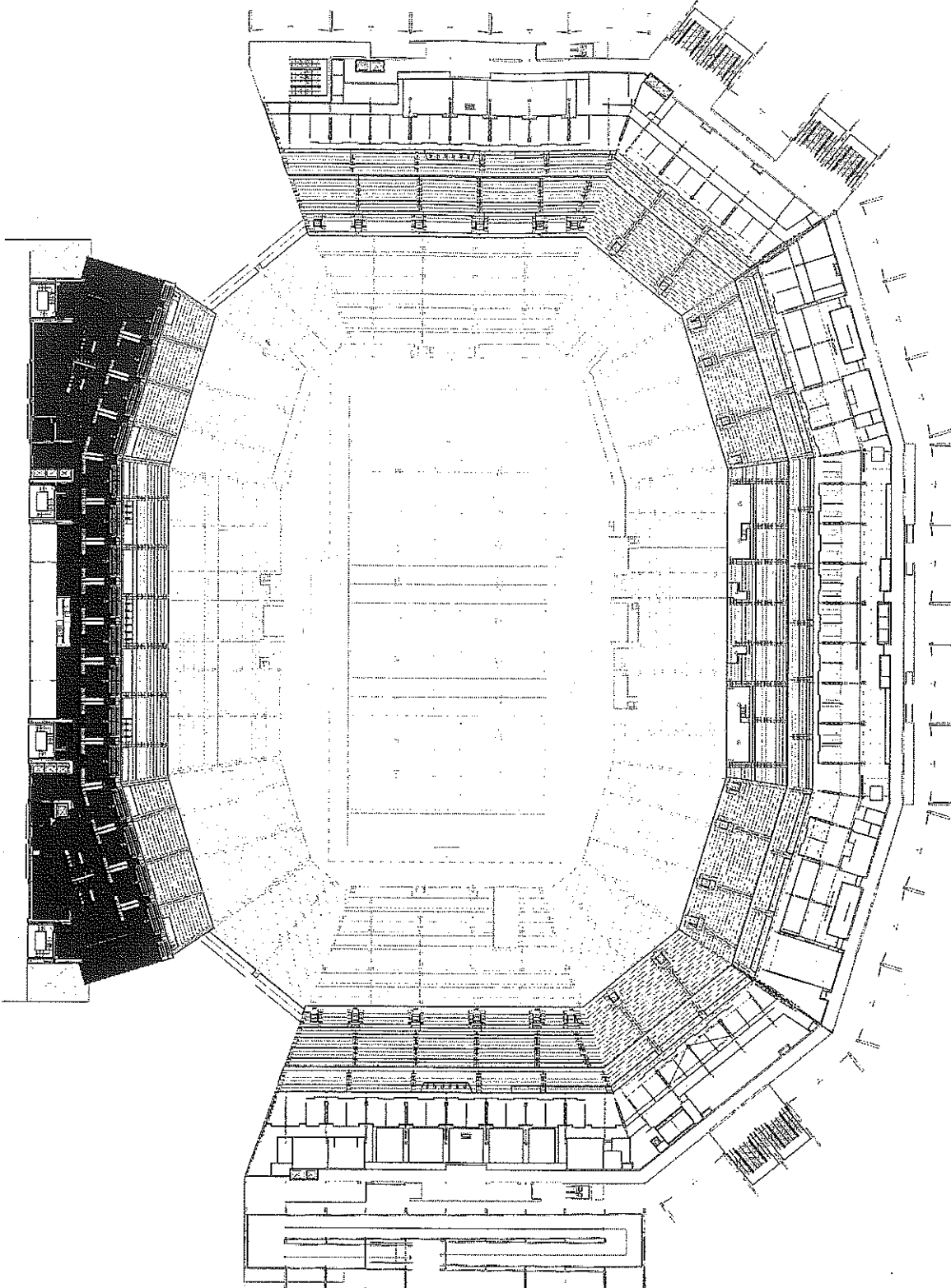

**LEGEND**

- 1. **STADIUM OPERATIONS AREAS**  
 Concessions  
 Restrooms  
 Ticket Office  
 Security Command  
 Rest  
 Roof  
 Day of Game Employee Briefing  
 Paper Goods Storage  
 Field Photographers  
 Cover Rooms  
 Main Reception  
 Press Box  
 Suite Care Dept. Department  
 Security Command  
 Storage  
 Day of Game Employee Briefing  
 Mechanical, Electrical, Plumbing  
 Cover Rooms  
 Main Reception
- 2. **TENANT'S EXCLUSIVE FACILITIES**
- 3. **HALL OF FAME**  
 (Tenant's Exclusive Facilities, Stadium Commercial Areas)
- 4. **TEAM STORE**  
 (Tenant's Exclusive Facilities, Stadium Commercial Areas)
- 5. **PREMIUM STADIUM AREAS**
- 6. **COMMUNITY ROOM**
- 7. **STADIUM AUTHORITY EXCLUSIVE FACILITIES**
- 8. **CLUB FACILITIES**  
 (Premium Stadium Areas)
- 9. **OWNER'S CLUB**  
 (Tenant's Exclusive Facilities)
- 10. **STADIUM COMMERCIAL AREAS**
- 11. **SUITE TOWER**  
 (Tenant's Exclusive Facilities)
- 12. **TENANT'S ADMINISTRATIVE SPACE**  
 (Tenant's Exclusive Facilities)
- 13. **STADIUM TICKET OFFICE**  
 (Tenant's Exclusive Facilities)
- 14. **STADIUM AUDIO / VIDEO FACILITIES**  
 (Tenant's Exclusive Facilities)

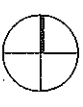

PLAN NORTH



March 15, 2012  
**600 LEVEL - SUITES**

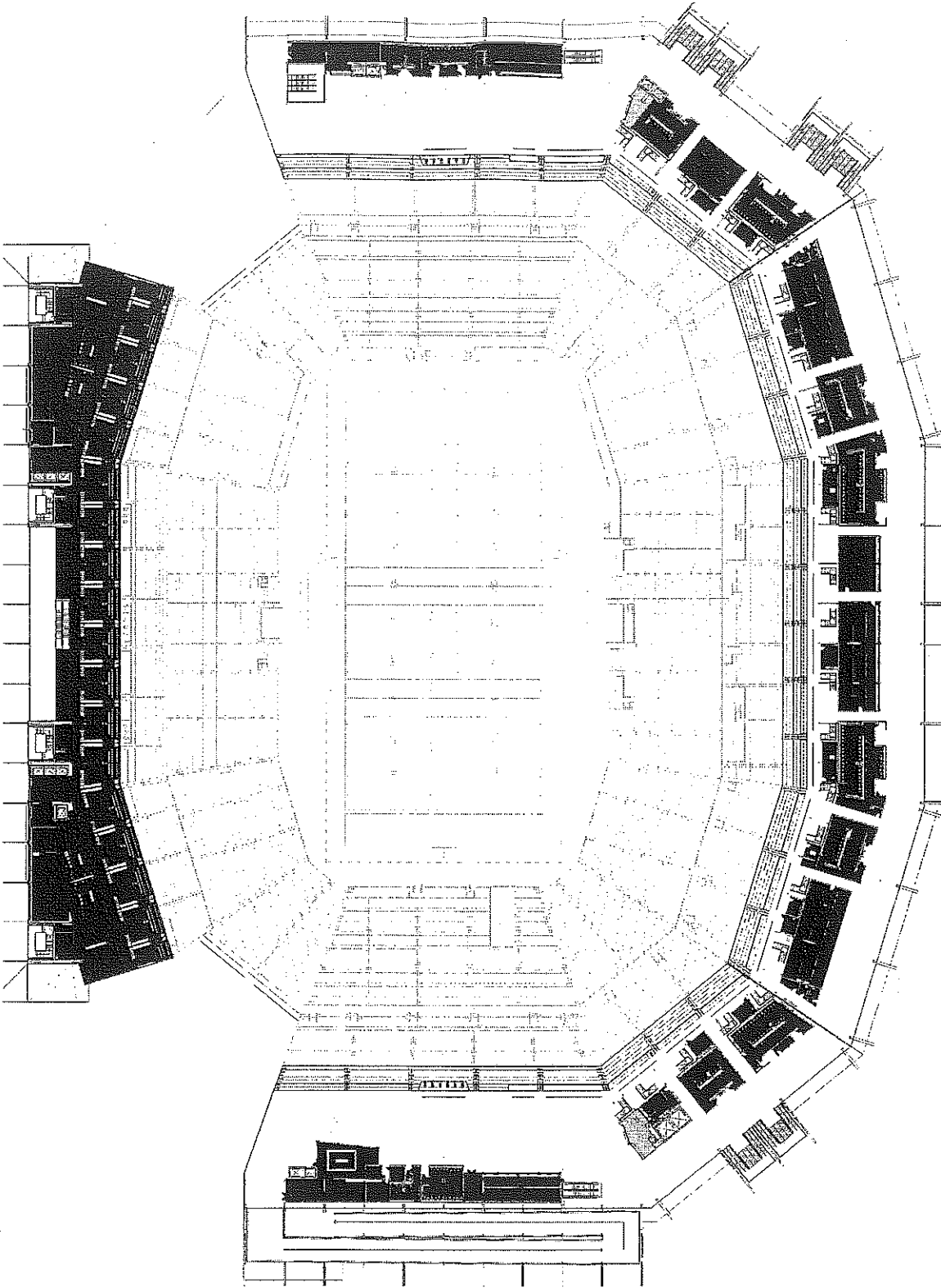

**LEGEND**

1. **STADIUM OPERATIONS AREAS**  
 Clubrooms  
 Stairwells  
 Security  
 Signage  
 Sports Club Police Department  
 Engineering  
 Back Office  
 Day of Game Employee Building  
 Auxiliary Locker Room  
 Field Photography  
 Green Room  
 Team Refreshing  
 Multi-Purpose Room
2. **TENANT'S EXCLUSIVE FACILITIES**
3. **HALL OF FAME**  
 (Tenant's Exclusive Facilities, Stadium Commercial Areas)
4. **TEAM STORE**  
 (Tenant's Exclusive Facilities, Stadium Commercial Areas)
5. **PREMIUM STADIUM AREAS**
6. **COMMUNITY ROOM**
7. **STADIUM AUTHORITY EXCLUSIVE FACILITIES**
8. **CLUB FACILITIES**  
 (Premium Stadium Areas)
9. **OWNER'S CLUB**  
 (Tenant's Exclusive Facilities)
10. **STADIUM COMMERCIAL AREAS**  
 (Tenant's Exclusive Facilities)
11. **SUITE TOWER**  
 (Tenant's Exclusive Facilities)
12. **TENANT'S ADMINISTRATIVE SPACE**  
 (Tenant's Exclusive Facilities)
13. **STADIUM TICKET OFFICE**  
 (Tenant's Exclusive Facilities)
14. **STADIUM AUDIO / VIDEO FACILITIES**  
 (Tenant's Exclusive Facilities)



PLAN NORTH

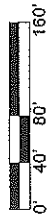

March 15, 2012  
**700 LEVEL - SUITES AND UPPER CONCOURSE**



**LEGEND**

**1. STADIUM OPERATIONS AREAS**

- Concessions
- Food Bar
- Restroom
- Seats Club Police Department
- Signage
- Stadium Office
- Day of Game Employee Briefing
- Auxiliary Ladies Room
- Auxiliary Men's Room
- Green Rooms
- Mall Purpose Room

**2. TENANT'S EXCLUSIVE FACILITIES**

**3. HALL OF FAME**  
(Tenant's Exclusive Facilities, Stadium Commercial Areas)

**4. TEAM STORE**  
(Tenant's Exclusive Facilities, Stadium Commercial Areas)

**5. PREMIUM STADIUM AREAS**

**6. COMMUNITY ROOM**

**7. STADIUM AUTHORITY EXCLUSIVE FACILITIES**

**8. CLUB FACILITIES**  
(Premium Stadium Areas)

**9. OWNER'S CLUB**  
(Tenant's Exclusive Facilities)

**10. STADIUM COMMERCIAL AREAS**

**11. SUITE TOWER**  
(Tenant's Exclusive Facilities)

**12. TENANT'S ADMINISTRATIVE SPACE**  
(Tenant's Exclusive Facilities)

**13. STADIUM TICKET OFFICE**  
(Tenant's Exclusive Facilities)

**14. STADIUM AUDIO / VIDEO FACILITIES**  
(Tenant's Exclusive Facilities)

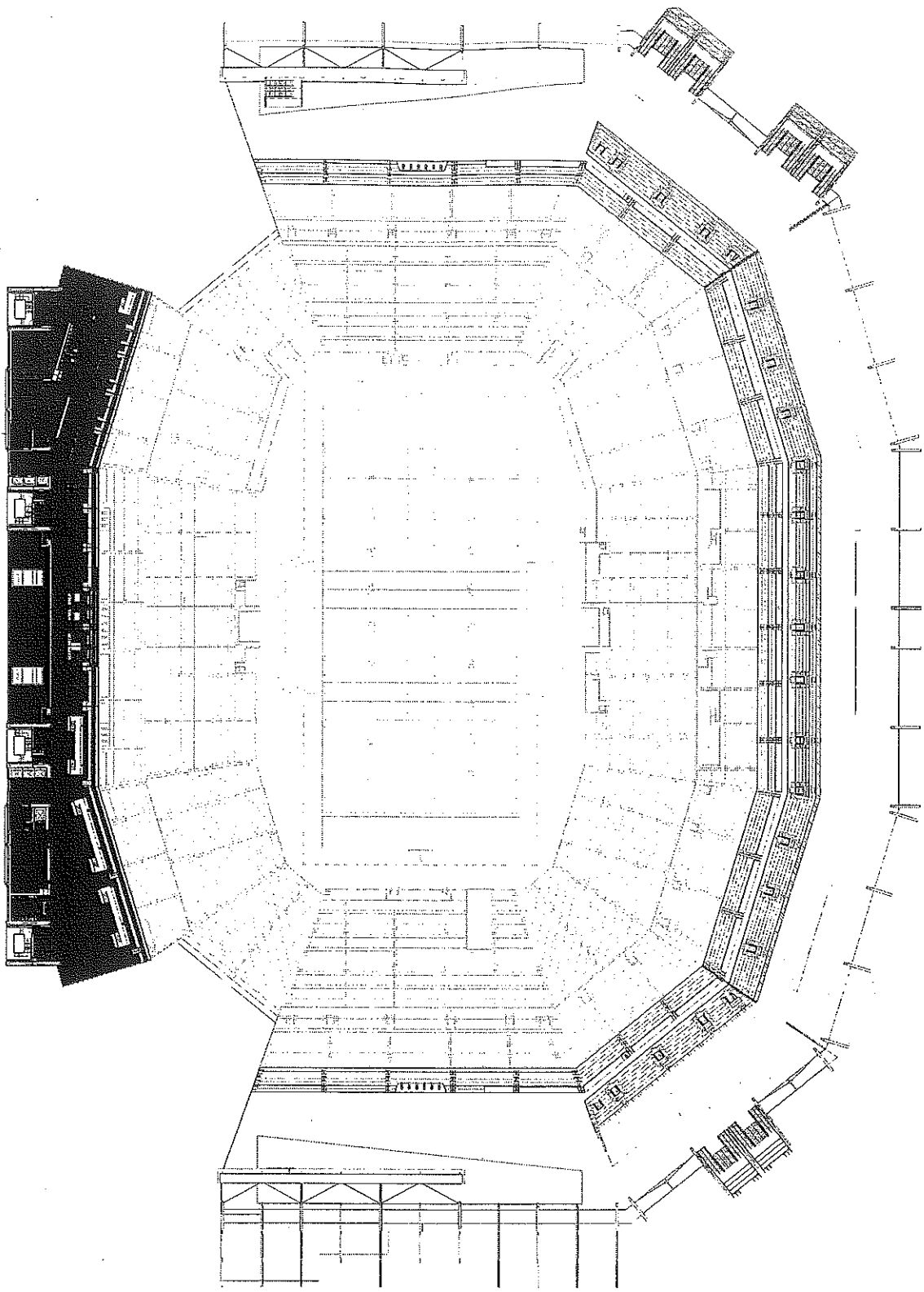

PLAN NORTH



March 15, 2012  
800 LEVEL - PRESS

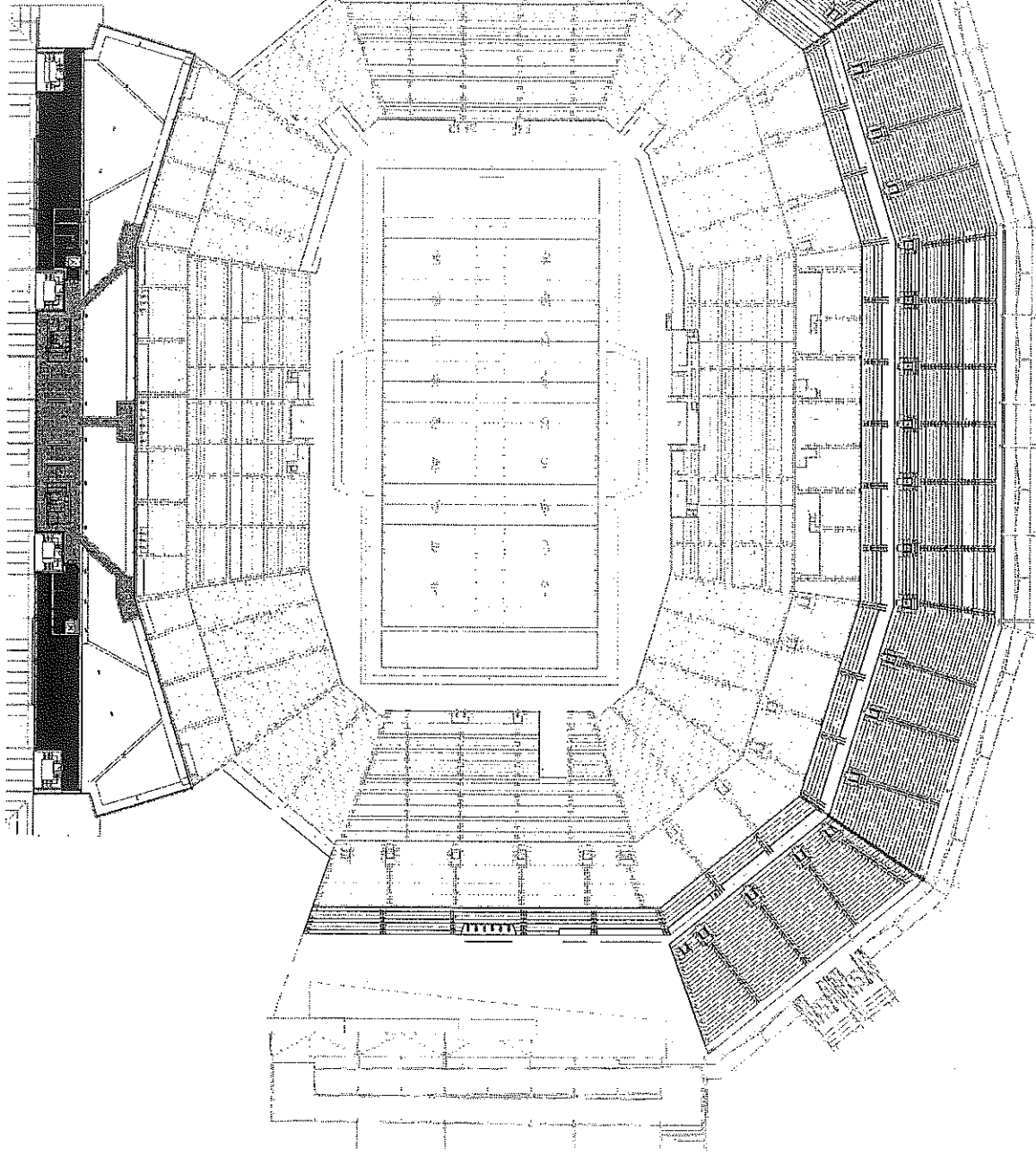

**LEGEND**

1. **STADIUM OPERATIONS AREAS**  
 Concessions  
 Restroom  
 Staff Management  
 Janitor / Custodial  
 Road  
 Day of Game Employee Staffing  
 Security Lounge / Alarm  
 Security Control Room / Pushing  
 Police / Security  
 Office / Restroom  
 Multi-Purpose Room
2. **TENANT'S EXCLUSIVE FACILITIES**
3. **HALL OF FAME**  
 (Tenant's Exclusive Facilities, Stadium Commercial Area)
4. **TEAM STORE**  
 (Tenant's Exclusive Facilities, Stadium Commercial Area)
5. **PREMIUM STADIUM AREAS**
6. **COMMUNITY ROOM**
7. **STADIUM AUTHORITY EXCLUSIVE FACILITIES**
8. **CLUB FACILITIES**  
 (Premium Stadium Areas)
9. **OWNER'S CLUB**  
 (Tenant's Exclusive Facilities)
10. **STADIUM COMMERCIAL AREAS**
11. **SUITE TOWER**  
 (Tenant's Exclusive Facilities)
12. **TENANT'S ADMINISTRATIVE SPACE**  
 (Tenant's Exclusive Facilities)
13. **STADIUM TICKET OFFICE**  
 (Tenant's Exclusive Facilities)
14. **STADIUM AUDIO / VIDEO FACILITIES**  
 (Tenant's Exclusive Facilities)

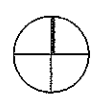

PLAN NORTH



March 15, 2012  
**900 LEVEL - TOWER ROOF AND UPPER DECK**

